

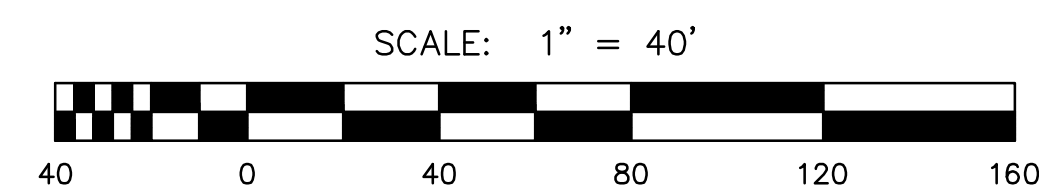

SPRINGFIELD DRIVE

STATE ROUTE 92' - R/W VARIES

STONECROFT LANE

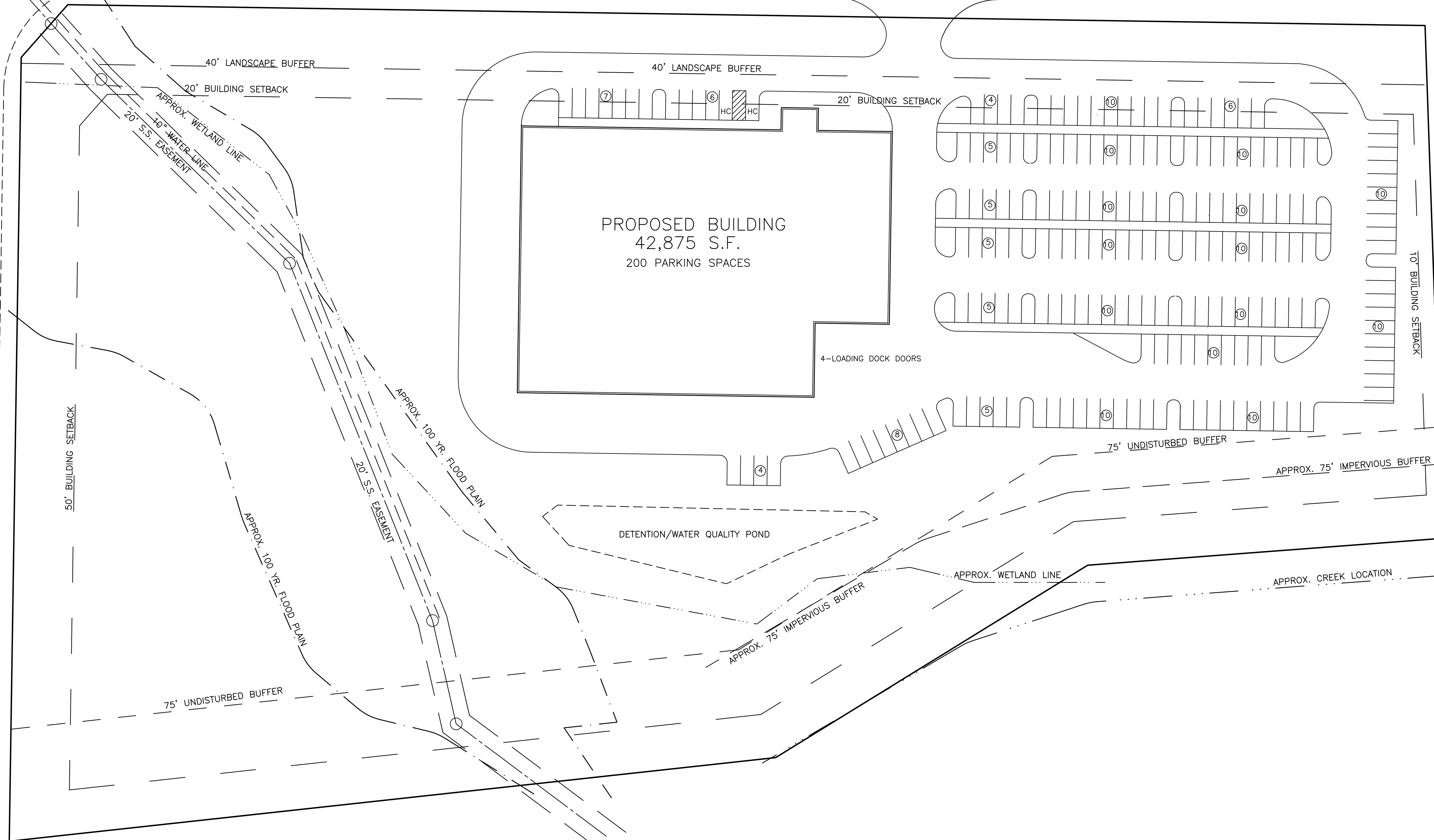

SITE AREA = 10.23 ACRE

THESE DRAWINGS ARE PROPRIETARY IN NATURE & REMAIN THE PROPERTY OF BRADFORD ENGINEERING. THEY MAY NOT BE REPRODUCED IN ANY FORM OR LOANED OUT WITHOUT WRITTEN PERMISSION FROM BRADFORD ENGINEERING.

DRAWINGS AND DETAILS MAY BE INCLUDED WHICH HAVE BEEN ENGINEERED BY PROFESSIONAL CONSULTANTS OR VENDORS, WHO ARE SOLELY RESPONSIBLE FOR THE CONTENT THEREIN.

THESE ARE NOT CERTIFIED ENGINEERING DRAWINGS UNLESS SIGNED AND SEALED BY A LICENSED PROFESSIONAL.

CONSULTANT
BRADFORD ENGINEERING, INC.
 CONSULTING ENGINEERS
 278 STONYBROOK DR.
 CANTON, GA. 30115
 OFFICE / FAX (770) 479-0122

PROJECT TITLE/NO:
RELIABLE HEATING & AIR ~ OFFICE/WAREHOUSE
LAND LOT 1209, DISTRICT 15, SECTION 2, CITY OF WOODSTOCK
CHEROKEE COUNTY, GEORGIA

OWNER/DEVELOPER:
 RELIABLE HEATING & AIR - 11075 HIGHWAY 92
 WOODSTOCK - GEORGIA 30188 - PHONE: (404) 626-2344

REVISIONS		
NO.	DESCRIPTION	DATE

TAX MAP REF.

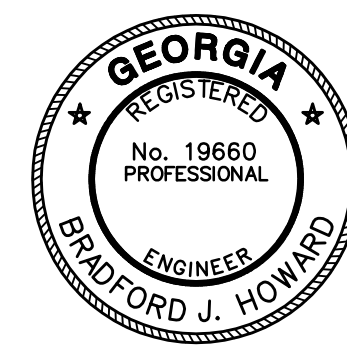

PRELIMINARY SITE PLAN	
DRAWN	SHEET NO.
BJH	<div style="font-size: 2em; font-weight: bold;">C~1</div>
CHECKED	
BJH	
PROJECT NO.	
DATE	
10-7-14	SHT. 1 OF 1